

MEMORANDUM

To: Robert Kosit, VBH Director of Administration
Brian Cecola, VBH Chairman Roads & Bridges

From: Dan Strahan, P.E., CFM
Gewalt Hamilton Associates (GHA)

Date: October 23, 2015

Re: Cuba Road Bridge Replacement Project
Preconstruction meeting summary

A preconstruction meeting for the Cuba Road Bridge replacement was held at IDOT on Thursday, October 20, 2015. Copenhagen Construction intends to begin the project as soon as possible. As discussed previously, the project requires a full closure of the road at the bridge with an accompanying detour route. Message boards describing the detour will be placed on Monday. The contractor plans to initiate the detour route on Monday, November 2, 2015 and begin work that week, pending IDOT approval.

Our office will send out notice of the closure and detour to Barrington Transportation Company, the Cuba Township Highway Department, waste haulers, police and fire departments, and the post office. We will also provide a letter to residents along Buckley Road, Cuba Road, and Merri Oaks Road to make sure those closest to the project are aware of the closure. We would recommend notice also be posted to the Village website.

During the bridge closure, traffic will still be able to turn from Buckley Road to Cuba Road east of Buckley and vice versa; however, traffic will not be able to turn from Merri-Oaks Road north onto West Cuba Road as this area is included in the closure due to construction storage and staging requirements. The road closure is expected to last throughout construction activities; the contract specifies that the road will be reopened to traffic by May 13, 2015.

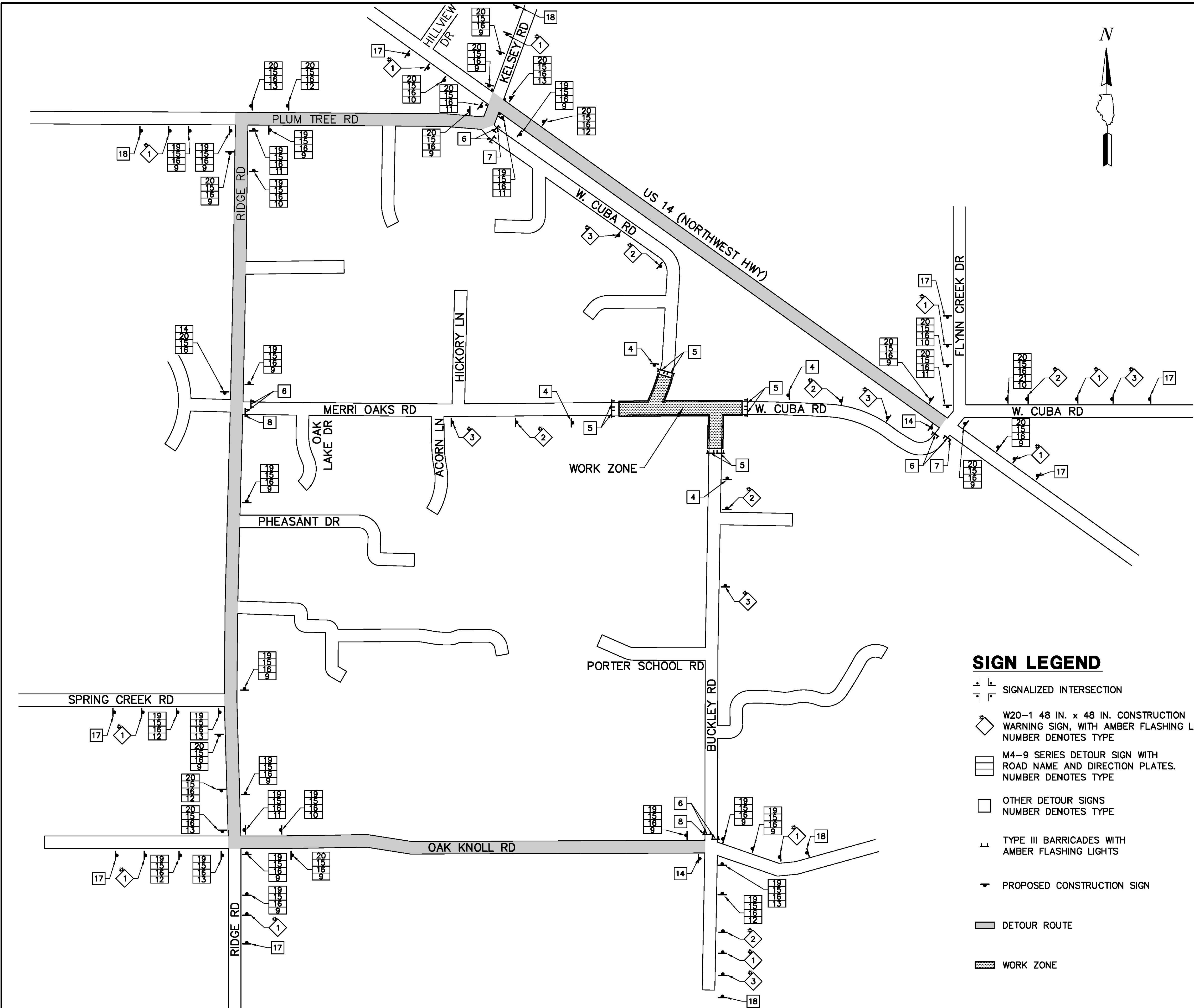

SIGN LEGEND

- SIGNALIZED INTERSECTION
- W20-1 48 IN. x 48 IN. CONSTRUCTION WARNING SIGN, WITH AMBER FLASHING LIGHT. NUMBER DENOTES TYPE
- M4-9 SERIES DETOUR SIGN WITH ROAD NAME AND DIRECTION PLATES. NUMBER DENOTES TYPE
- OTHER DETOUR SIGNS NUMBER DENOTES TYPE
- TYPE III BARRICADES WITH AMBER FLASHING LIGHTS
- PROPOSED CONSTRUCTION SIGN
- DETOUR ROUTE
- WORK ZONE

SCHEDULE OF QUANTITIES

SIGN NO.	SIGN TYPE	
1	DETOUR AHEAD	W20-2 (0) 48
2	ROAD CLOSED 500 FT	W20-3 (0) 48
3	ROAD CLOSED AHEAD	W20-3 (0) 48
4	ROAD WILL BE CLOSED FROM MAIN RD THRU MAIN RD	ARTERIAL ROAD INFORMATION SIGN FOR ROADS TO BE FULLY CLOSED AND DETOURED
5	ROAD CLOSED	R11-2 4830
6	ROAD CLOSED 1/2 MILE AHEAD LOCAL TRAFFIC ONLY	R11-3 6030
7	DETOUR	M4-10R (0) 4818
8	DETOUR	M4-10L (0) 4818
9	DETOUR	M4-9 (0) 3024
10	DETOUR	M4-9R (0) 3024
11	DETOUR	M4-9R (0) 3024
12	DETOUR	M4-9L (0) 3024
13	DETOUR	M4-9L (0) 3024
14	END DETOUR	M4-8a (0) 2418
15	Cuba Rd	SPECIAL (0) 9 VARIABLE
16	Merri Oaks Rd	SPECIAL (0) 9 VARIABLE
17	Cuba Rd/Merri Oaks Rd CLOSED TO THRU TRAFFIC USE Plum Tree Rd	SPECIAL (0) 6030
18	Cuba Rd/Buckley Rd CLOSED TO THRU TRAFFIC USE Ridge Rd	SPECIAL (0) 6030
19	EAST	M3-2 (0) 2412
20	WEST	M3-4 (0) 2412
21	DETOUR SECOND RIGHT	CUSTOM

NOTE: THE CONTRACTOR SHALL NOTIFY LAKE COUNTY PASSAGE TWO WEEKS BEFORE THE DETOUR IS IMPLEMENTED.

TYPICAL DETOUR SIGN ASSEMBLY

SIGN NO. -	
SIGN NO. -	
SIGN NO. -	



Sources: Esri World Imagery



1 inch = 1,000 Feet

Map Center: -88.18542 42.17616

Road Closure Overview

Cuba Road Bridge
Barrington Hills, IL

Date: 10/23/2015 Project: 9355.123

File: P:\8101-9499\9355 Barrington Hills\9355.123 Cuba Road Bridge Phase One Report\GIS\Maping\CubaRdBridge_RoadClosureOverview.mxd
Drawn By: gnewton

Legend

 Area of Closure

Area of Closure

Access to be Maintained

Merri-Oaks Road

Cuba Road

Buckley Road



Source: Esri, DigitalGlobe, GeoEye, Earthstar Geographics, CNES/Airbus DS, USDA, USGS, AEX, Getmapping, Aerogrid, IGN, IGP, swisstopo, and the GIS User Community



1 inch =  100 Feet

Road Closure Map

Cuba Road Bridge
Barrington Hills, IL

Legend

 Area of Closure

Area of Closure

Access to be Maintained

Merri-Oaks Road

Cuba Road

Buckley Road



Source: Esri, DigitalGlobe, GeoEye, Earthstar Geographics, CNES/Airbus DS, USDA, USGS, AEX, Getmapping, Aerogrid, IGN, IGP, swisstopo, and the GIS User Community



1 inch =  100 Feet

Road Closure Map

Cuba Road Bridge
Barrington Hills, IL